



65 WW

WHISPER Wheel



Specifications

- Wheel Type:** Semi-Precision
- Load Capacity:** 65 lbs.
- Impact Rating:** 100 lbs.
- Body Diameter:** 1-15/16"
- Bore Size & Type:** 1/4" – Round; Length 13/16"
- Lubrication:** Oil
- Ball Complement:** (10) – 3/16" Diameter
- Material:** Zinc Plated Steel, Nylon Ball Separator, Hardened Steel Balls & Raceways
- Temperature Range:** -22°F to 248°F

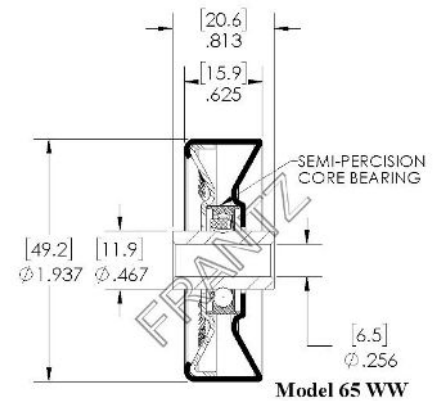

Part Number for Ordering:
Oil - 65WW316000

Applications: Benefits & Features

- Impact Rating:** FRANTZ not only tests steel conveyor wheels for cycle revolutions under load, but also performs impact testing under ANSI spec ICWM:2012 which was developed for the caster industry. Impact rating provides user confidence in applications with heavy weight or load "impact zones".
- Targeted Applications:** Utilize for noise abatement in conveyors. Skate wheels for straight or curved gravity flow conveyor applications, extendable conveyors, spur conveyor, flow rails, wheel rails and lift gates. Used primarily in Shipping, Warehousing and Assembly.
- Performance:** Bench tested at greater than 15 million revolutions @ 400 RPM.

...Roll Easy with FRANTZ®

FRANTZ

Customer Service, Product Samples and Quotations: 815.625.7063

FRANTZ Manufacturing Company P.O. Box 497, Sterling IL 61081-0497 www.frantz-mfg.com