



65

Conveyor / Skate Wheel



Specifications

- Wheel Type:** Non-Precision
- Load Capacity:** 65 lbs.
- Impact Rating:** 100 lbs.
- Body Diameter:** 1-15/16"
- Bore Size & Type:** 1/4" – Round; Length 13/16"
- Lubrication:** Oil
- Ball Complement:** (10) – 3/16" Diameter
- Material:** Zinc Plated Steel, Hardened Steel Balls & Raceways
- Temperature Range:** Oil, -4 to 400 F°
- Regreasable:** No – Maintenance Free

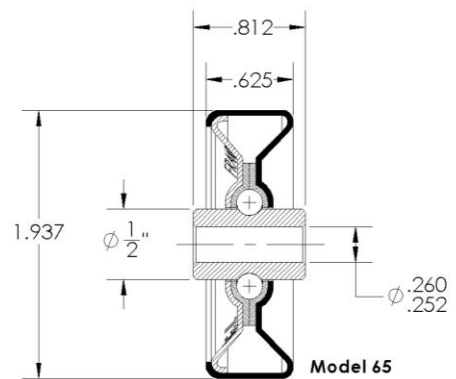

Part Number for Ordering:
Oil - 0065316000

Applications: Benefits & Features

- Impact Rating:** FRANTZ not only tests steel conveyor wheels for cycle revolutions under load, but also performs impact testing under ANSI spec ICWM:2012 which was developed for the caster industry. Impact rating provides user confidence in applications with heavy weight or load "impact zones".
- Targeted Applications:** Conveyor / skate wheels for straight or curved gravity flow conveyor applications, extendable conveyors, spur conveyor, flow rails, wheel rails and lift gates. Used primarily in Shipping, Warehousing and Assembly.
- Long Life:** FRANTZ conveyor skate wheels are engineered and manufactured to exceed the CEMA standard of one million revolutions. The 65 oil version has been bench tested at 400 RPM and **exceeded CEMA standards by 5X**, permitting high performance in conveying applications.

...Roll Easy with FRANTZ®

FRANTZ

Customer Service, Product Samples and Quotations: 815.625.7063

FRANTZ Manufacturing Company P.O. Box 497, Sterling IL 61081-0497 www.frantz-mfg.com